

## **Appendices**

15/0224/VARY

Application to vary condition no.11 (opening hours) of planning approval 13/1721/REV (Revised application for the replacement of existing buildings with 3 retail units) to extend the opening hours of unit 1 from 8:30am to 9:30pm all days of the week (inc bank holidays) and Unit 2 from 8.30am to 11.00pm all days of the week (inc bank holidays) and unit 3 from 7am to 11pm all days of the week (inc Bank Holidays).

331 - 343 Norton Road, Norton, Stockton-on-Tees, TS20 2PT

1. Location plan (extract from approved plan 11-1034.01 rev A15 from approval 13/1721/REV)
2. Approved existing site plan (extract from approved plan 11-1034.01 rev A15 from approval 13/1721/REV)
3. Approved proposed site plan (extract from approved plan 11-1034.01 rev A15 from approval 13/1721/REV)
4. Approved proposed ground floor plan (extract from approved plan 11-1034.01 rev A15 from approval 13/1721/REV)

1. Location plan (extract from approved plan 11-1034.01 rev A15 from approval 13/1721/REV)

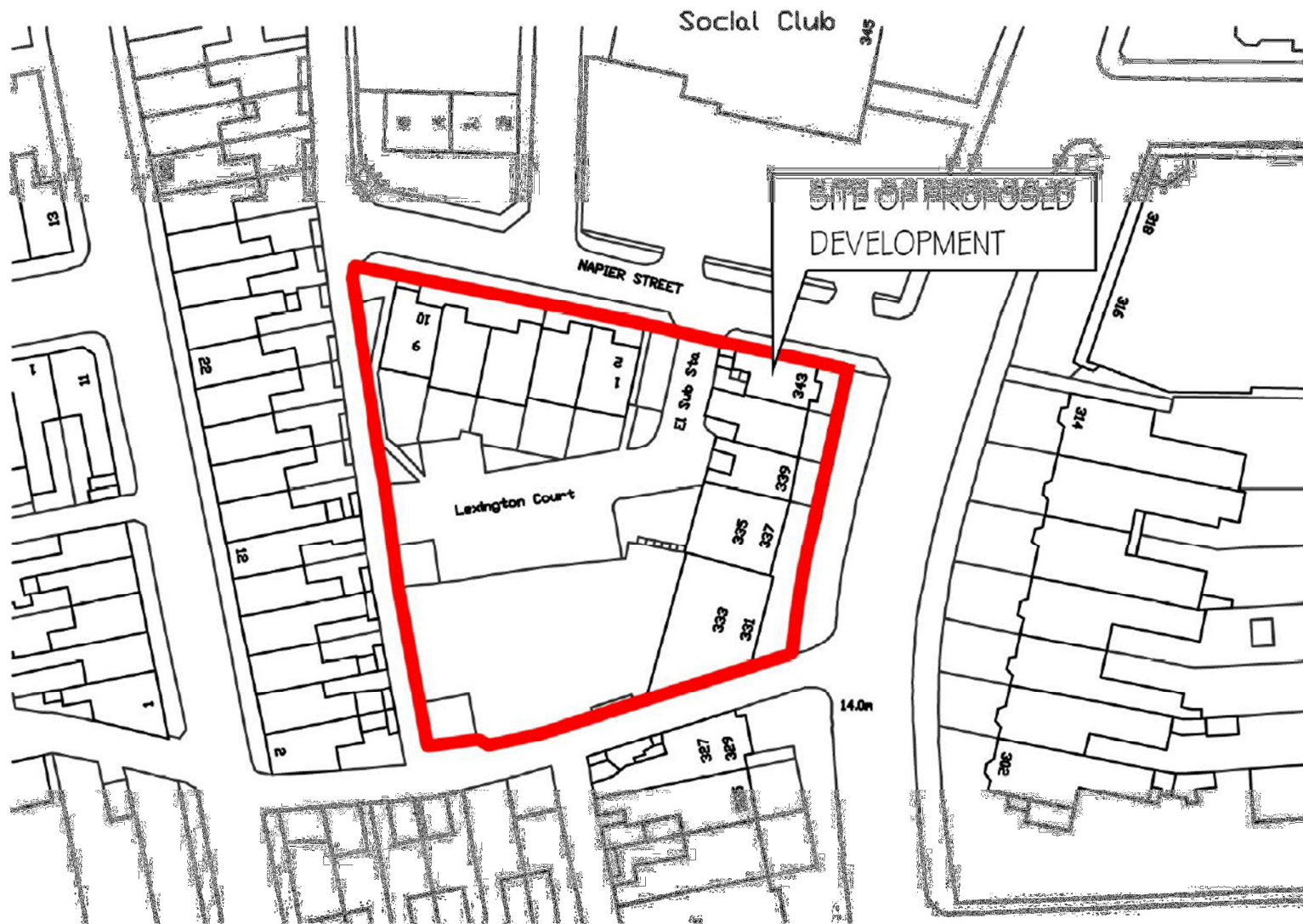

2. Approved existing site plan (extract from approved plan 11-1034.01 rev A15 from approval 13/1721/REV)



**EXISTING SITE PLAN**  
**SCALE: 1:500**

3. Approved proposed site plan (extract from approved plan 11-1034.01 rev A15 from approval 13/1721/REV)

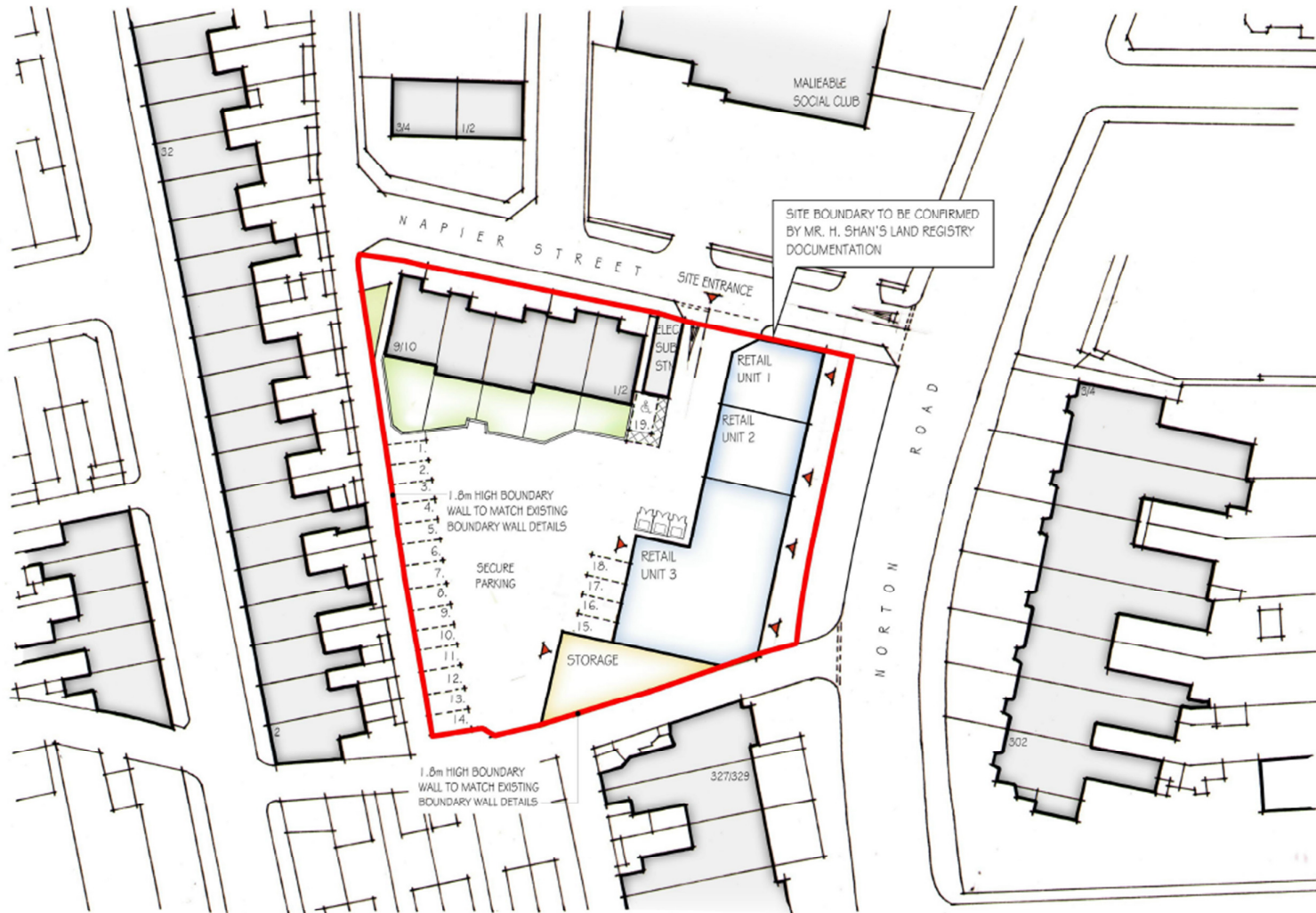

**PROPOSED SITE PLAN**  
**SCALE: 1:500**

4. Approved proposed ground floor plan (extract from approved plan 11-1034.01 rev A15 from approval 13/1721/REV)



**PROPOSED GROUND FLOOR PLAN**  
SCALE: 1:200